

Public Document Pack
Bridgend County Borough Council
Cyngor Bwrdeistref Sirol Pen-y-bont ar Ogwr



Civic Offices, Angel Street, Bridgend, CF31 4WB / Swyddfeydd Dinesig, Stryd yr Angel, Pen-y-bont, CF31 4WB

Legal and Regulatory Services /
Gwasanaethau Cyfreithiol a Rheoleiddiol
Direct line / Deialu uniongyrchol: 01656 643148
Ask for / Gofynnwch am: Mr Mark Anthony Galvin

Our ref / Ein cyf:
Your ref / Eich cyf:

Date / Dyddiad: 11 March 2016

Dear Councillor,

LICENSING ACT 2003 SUB-COMMITTEE (A)

A meeting of the Licensing Act 2003 Sub-Committee (A) will be held in Committee Room 2/3, Civic Offices, Angel Street, Bridgend on **Thursday, 17 March 2016 at 10.00 am.**

AGENDA

1. Apologies for Absence
To receive apologies for absence from Members.
2. Declarations of Interest
To receive Declarations of personal and prejudicial interest (if any) from members/ officers in accordance with the provisions of the Members Code of Conduct adopted by Council from the 1st September 2008.
3. Application for Club Premises Certificate - Porthcawl Athletic Association, Porthcawl 3 - 42

Yours faithfully

P A Jolley

Assistant Chief Executive Legal and Regulatory Services

Distribution:

Councillors:
JE Lewis

Councillors
HE Morgan

Councillors
R Williams

This page is intentionally left blank

BRIDGEND COUNTY BOROUGH COUNCIL

REPORT TO LICENSING SUB COMMITTEE

17 MARCH 2016

REPORT OF THE ASSISTANT CHIEF EXECUTIVE LEGAL AND REGULATORY SERVICES

LICENSING ACT 2003 : SECTION 71 APPLICATION FOR CLUB PREMISES CERTIFICATE PORTHCAWL ATHLETIC ASSOCIATION LOCKS LANE PORTHCAWL

1. Purpose of Report

- 1.1 This application is submitted by the Porthcawl Athletic Association for the grant of a Club Premises Certificate at the Club House. The person proposed to act as Secretary for the purposes of the Act is Peter Downes.
- 1.2 The premises is described as a Club House room with a corner section to serve as a kitchen/bar area. The premises also includes changing rooms and toilets.

2. Connection to Corporate Improvement Plan / Other Corporate Priority

- 2.1 None.

3. Background

- 3.1 A copy of the application form is attached at Appendix A together with a location plan.
- 3.2 The application is for a Club Premises Certificate to authorise the supply of alcohol by or on behalf of a club to, or to the order of, a member of the club and the sale by retail of alcohol by or on behalf of a club to a guest of a member of the club for consumption on the premises only, as follows:

Mondays to Thursdays 1900 to 2200 hours
Fridays 1900 to 2300 hours
Saturdays 1200 to 2300 hours
Sundays 1200 to 1800 hours

These are standard hours and no seasonal variations have been applied for.

Other licensable activities include indoor sporting events and recorded music within the above times, and live music on Friday and Saturdays only between 1900 and 2300 hours. All activities to take place indoors.

The operating schedule includes the hours the club premises are to be open to the members and guests

Mondays to Thursdays 1000 to 2230 hours

Fridays 1000 to 2330 hours

Saturdays 1000 to 2330 hours

Sundays 1000 to 1830 hours

- 3.3 The application has been advertised in accordance with Regulations, on site, in a local newspaper and on the Council's website.

4. Current situation / proposal.

- 4.1 Representations have been received from members of the public. Copies of the representations are attached at Appendices B to F.

- 4.2 At the time this report was prepared these representations had not been withdrawn.

- 4.3 In order to determine the application, the authority must first be satisfied that the club is a qualifying club. As set down in the Home Office Guidance to licensing authorities, clubs are organisations where members have joined together for particular social, sporting or political purposes. They may then combine to buy alcohol in bulk as members of the organisation to supply in the club. A Club operates under its own Rules of membership and conduct.

- 4.4 The authority may only grant a Club Premises Certificate to a qualifying club which means meeting certain conditions set out below. Section 62 of the 2003 Act sets out five general conditions which a relevant club must meet to be a qualifying club.

- 4.5 Porthcawl Athletic Association has submitted a declaration under Section 61 of the Act which sets out how it proposes to meet these five general conditions. One of these conditions is that the authority must be satisfied that the club is established and conducted in good faith and Section 63 of the Act sets out how the authority assesses whether this is the case. Having considered the declaration, officers are satisfied that the Porthcawl Athletic Association meets the qualifying club conditions.

- 4.6 The Sub-Committee must have regard to the Council's Statement of Licensing Policy and the Home Office guidance, however, the Sub-Committee must consider each application on its own merits have regard to the application and the representations made. Home Office Guidance Section 6 applies to this application, together with Sections 9 and 10. There is no specific policy for the grant of Club Premises Certificates within the Bridgend County Borough Council Statement of Licensing Policy.

- 4.7 Members are advised that following initial representations, the applicant has been in discussion with the South Wales Police and Council licensing authority officer and has agreed to a number of additional conditions forming part of the operating schedule to the certificate, if granted. These additional matters are shown in Appendix G to this report. As a result, there are no responsible authority representations to be considered at this hearing.

4.8 Members are also advised that all matters contained in the operating schedule in Section L (a) to (e) of the application would be translated into conditions on the certificate, if granted.

5. Effect upon Policy Framework & Procedure Rules.

5.1 None

6. Equality Impact Assessment.

6.1 A full Equality Impact Assessment has not been undertaken in relation to this service, however due regard has been given to the implications on persons protected by equality legislation and human rights. Adverse impact of this Legislation on the equality protected groups is very unlikely. Consideration has been given to the guidance issued to accompany the Licensing Act 2003 relating to need to eliminate duplication and conflict with existing disability legislation and to reference and highlight the Council's Race Equality Scheme, policies and codes of conduct to applicants. We do not consider, on the basis of the above, that a detailed Equality Impact Assessment is required for this service. In line with our Inclusive Equalities Scheme we will monitor for any adverse impacts that may develop.

7. Financial Implications.

7.1 None

8. Recommendation.

8.1 The Sub-Committee is asked to determine the application;

having regard to the application information, the representations submitted, together with the Council's Statement of Licensing Policy and the Guidance issued by the Secretary of State. In doing so, the Sub-Committee is requested to confirm whether any additional conditions are to be imposed or only those which are consistent with and set out in the operating schedule. The Sub-Committee shall provide a statement of reasons to accompany the determination.

Andrew Jolley
Assistant Chief Executive Legal and Regulatory Services

Date: 11 March 2016

Contact Officer: Yvonne Witchell
Team Manager Licensing

Telephone: (01656) 643105

E-mail: Yvonne.Witchell@bridgend.gov.uk

Postal Address Civic Offices, Angel Street, Bridgend, CF31 4WB

Background documents

Application for Club Premises Certificate

Copies of various representations received from Members of the Public

Council's Statement of Licensing Policy available at www.bridgend.gov.uk

Amended Guidance issued under Section 182 of the Licensing Act 2003 available at www.homeoffice.gov.uk

[Insert name and address of club and its reference number (optional)]

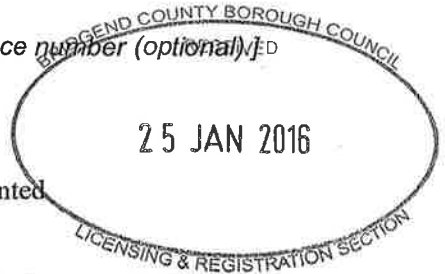

Application for a club premises certificate to be granted under the Licensing Act 2003

PLEASE READ THE FOLLOWING INSTRUCTIONS BEFORE COMPLETING APPLICATION

Before completing this form please read the guidance notes at the end of the form. If you are completing this form by hand please write legibly in block capitals. In all cases ensure that your answers are inside the boxes and written in black ink. Use additional sheets if necessary. You may wish to keep a copy of the completed form for your records.

PORTHCAWL ATHLETIC ASSOCIATION

(Insert name of club)

club applies for a club premises certificate under section 71 of the Licensing Act 2003 for the premises described in Part 1 below (the club premises).

The club is making this application to you as the relevant licensing authority in accordance with section 68 of the Licensing Act 2003.

Part 1 – Club premises details

Name of club			
PORTHCAWL ATHLETIC ASSOCIATION			
Postal address of premises or, if none, ordnance survey map reference or description			
WOCKS LANE (OPP STRATFORD DRIVE) -			
Post Town	PORTHCAWL	Postcode	CF36 3HY
Telephone number (if any)			
E-mail address (optional)			

Name of contact	
Address	
Post To	
Daytime number	

E-mail address (optional) [REDACTED]

Non-domestic rateable value of premises £ /

Are the club premises occupied and habitually used by the club? Yes No

Part 2 – Club Operating Schedule

When do you want the club premises certificate to start? DD MM YYYY
|_| |_| |_| |_| |_| |_| |_| |_|

If you wish the certificate to be valid only for a limited period, when do you want it to end? DD MM YYYY
|_| |_| |_| |_| |_| |_| |_| |_|

General description of club (please read guidance note 1)
THE CLUBHOUSE CONSISTS OF ONE LARGE ROOM WITH A CORNER SECTION TO SERVE AS A KITCHEN/BAR AREA. THERE IS A MAIN ENTRANCE DOOR, A DOOR ONTO THE PATIO AREA AND ONE OTHER EXIT. THE KITCHEN AREA HAS A EXIT DOOR. OFF OF THE MAIN ROOM ARE LADIES, GENTS AND DISABLED TOILETS. ATTACHED BUT WITH SEPARATE ACCESS AT THE REAR ARE TWO CHANGING ROOMS WITH SHOWERS.

If 5,000 or more people are expected to attend the premises at any one time, please state the number expected to attend: N/A.

What qualifying club activities do you intend to conduct on the club premises?

- Provision of regulated entertainment **Please tick all that apply**
- a) plays (if ticking yes, fill in box A)
 - b) films (if ticking yes, fill in box B)
 - c) indoor sporting events (if ticking yes, fill in box C)
 - d) boxing or wrestling entertainment (if ticking yes, fill in box D)
 - e) live music (if ticking yes, fill in box E)
 - f) recorded music (if ticking yes, fill in box F)
 - g) performances of dance (if ticking yes, fill in box G)
 - h) anything of a similar description to that falling within (e), (f) or (g) (if ticking yes, fill in box H)

The supply of alcohol by or on behalf of a club to, or to the order of, a member of the club (if ticking yes, fill in box I)

The sale by retail of alcohol by or on behalf of a club to a guest of a member of the club for consumption on the premises where the sale takes place (if ticking yes, fill in box J)

In all cases complete boxes, K and L.

A

Plays Standard days and timings (please read guidance note 6)			Will the performance of a play take place indoors or outdoors or both – please tick (please read guidance note 2)	Indoors	<input type="checkbox"/>			
				Outdoors	<input type="checkbox"/>			
				Both	<input type="checkbox"/>			
Day	Start	Finish	Please give further details here (please read guidance note 3)					
Mon								
Tue								
Wed						State any seasonal variations for performing plays (please read guidance note 4)		
Thur								
Fri						Non standard timings. Where the club intends to use the premises for the performance of a play at different times from those listed in the column on the left, please list (please read guidance note 5)		
Sat								
Sun								

B

Films Standard days and timings (please read guidance note 6)			<u>Will the exhibition of films take place indoors or outdoors or both – please tick</u> (please read guidance note 2)	Indoors	<input type="checkbox"/>
				Outdoors	<input type="checkbox"/>
				Both	<input type="checkbox"/>
Day	Start	Finish	<u>Please give further details here</u> (please read guidance note 3)		
Mon					
Tue			<u>State any seasonal variations for the exhibition of film</u> (please read guidance note 4)		
Wed					
Thur			<u>Non standard timings. Where the club intends to use the premises for the exhibition of film at different times from those listed in the column on the left, please list</u> (please read guidance note 5)		
Fri					
Sat					
Sun					

C

Indoor sporting events Standard days and timings (please read guidance note 6)			Please give further details here (please read guidance note 3)
Day	Start	Finish	
Mon	19.00	22.30	Possibly darts and/or Pool Teams in the future.
Tue	19.00	22.30	State any seasonal variations for indoor sporting events (please read guidance note 4)
Wed	19.00	22.30	
Thur	19.00	22.30	Non-standard timings. Where the club intends to use the premises for indoor sporting events at different times from those listed in the column on the left, please list (please read guidance note 5)
Fri	19.00	22.30	
Sat			
Sun			

D

Boxing or wrestling entertainments Standard days and timings (please read guidance note 6)			<u>Will the boxing or wrestling entertainment take place indoors or outdoors or both – please tick</u> (please read guidance note 2)	Indoors	<input type="checkbox"/>
Day	Start	Finish		Outdoors	<input type="checkbox"/>
Mon			<u>Please give further details here</u> (please read guidance note 3)	Both	<input type="checkbox"/>
Tue					
Wed			<u>State any seasonal variations for boxing or wrestling entertainment</u> (please read guidance note 4)		
Thur					
Fri			<u>Non-standard timings. Where the club intends to use the premises for the boxing or wrestling entertainment at different times from those listed in the column on the left, please list</u> (please read guidance note 5)		
Sat					
Sun					

E

Live music Standard days and timings (please read guidance note 6)			Will the performance of live music take place indoors or outdoors or both – please tick (please read guidance note 2)	Indoors	<input checked="" type="checkbox"/>
				Outdoors	<input type="checkbox"/>
				Both	<input type="checkbox"/>
Day	Start	Finish	<u>Please give further details here</u> (please read guidance note 3)		
Mon					
Tue					
Wed			<u>State any seasonal variations for the performance of live music</u> (please read guidance note 4)		
Thur					
Fri	19.00	23.00	<u>Non-standard timings. Where the club intends to use the premises for the performance of live music at different times from those listed in the column on the left, please list</u> (please read guidance note 5) ON LIMITED FUND RAISING OCCASIONS. AMPLIFIER MAY BE USED.		
Sat	19.00	23.00			
Sun					

F

Recorded music Standard days and timings (please read guidance note 6)			Will the playing of recorded music take place indoors or outdoors or both – please tick (please read guidance note 2)	Indoors	<input checked="" type="checkbox"/>
				Outdoors	<input type="checkbox"/>
				Both	<input type="checkbox"/>
Day	Start	Finish	Please give further details here (please read guidance note 3)		
Mon	19.00	22.00	UNAMPLIFIED		
Tue	19.00	22.00			
Wed	19.00	22.00	State any seasonal variations for the playing of recorded music (please read guidance note 4)		
Thur	19.00	22.00			
Fri	19.00	23.00	Non-standard timings. Where the club intends to use the premises for the playing of recorded music at different times from those listed in the column on the left, please list (please read guidance note 5)		
Sat	19.00	23.00			
Sun	12.00	18.00			

G

Performances of dance Standard days and timings (please read guidance note 6)			<u>Will the performance of dance take place indoors or outdoors or both – please tick</u> (please read guidance note 2)		Indoors	<input type="checkbox"/>
					Outdoors	<input type="checkbox"/>
					Both	<input type="checkbox"/>
Day	Start	Finish	<u>Please give further details here</u> (please read guidance note 3)			
Mon						
Tue						
Wed			<u>State any seasonal variations for the performance of dance</u> (please read guidance note 4)			
Thur						
Fri			<u>Non-standard timings. Where the club intends to use the premises for the performance of dance at different times from those listed in the column on the left, please list</u> (please read guidance note 5)			
Sat						
Sun						

H

Anything of a similar description to that falling within (e), (f) or (g) Standard days and timings (please read guidance note 6)			Please give a description of the type of entertainment that the club will be providing		
Day	Start	Finish	Will this entertainment take place indoors or outdoors or both – please tick (please read guidance note 2)	Indoors	<input type="checkbox"/>
Mon				Outdoors	<input type="checkbox"/>
				Both	<input type="checkbox"/>
Tue			Please give further details here (please read guidance note 3)		
Wed					
Thur			State any seasonal variations for this entertainment (please read guidance note 4)		
Fri					
Sat			Non-standard timings. Where the club intends to use the premises for this entertainment at different times from those listed in the column on the left, please list (please read guidance note 5)		
Sun					

I

Supply of alcohol Standard days and timings (please read guidance note 6)			<u>Will the supply of alcohol be for consumption - please tick</u> (please read guidance note 7)	On the premises	<input checked="" type="checkbox"/>			
				Off the premises	<input type="checkbox"/>			
				Both	<input type="checkbox"/>			
Day	Start	Finish	<u>State any seasonal variations</u> (please read guidance note 4)					
Mon	19.00	22.00						
Tue	19.00	22.00						
Wed	19.00	22.00						
Thur	19.00	22.00						
Fri	19.00	23.00						
Sat	12.00	23.00						
Sun	12.00	18.00						
						<u>Non-standard timings. Where the club intends to use the premises for the supply of alcohol at different times from those listed in the column on the left, please list</u> (please read guidance note 5)		

J

Hours club premises are open to the members and guests Standard days and timings (please read guidance note 6)			State any seasonal variations (please read guidance note 4)
Day	Start	Finish	
Mon	10.00	22.30	Non standard timings. Where you intend the premises to be open to the members and guests at different times from those listed in the column on the left, please list (please read guidance note 5)
Tue	10.00	22.30	
Wed	10.00	22.30	
Thur	10.00	22.30	
Fri	10.00	23.30	
Sat	10.00	23.30	
Sun	10.00	18.30	

K

Please highlight any adult entertainment or services, activities, or other entertainment or matters ancillary to the use of the club premises that may give rise to concern in respect of children (please read guidance note 8).

L Describe the steps you intend to take to promote the four licensing objectives:

a) General – all four licensing objectives (b,c,d,e) (please read guidance note 9)

ALL STAFF WILL BE TRAINED ON THE ASPECTS OF THE FOUR LICENSING OBJECTIVES.
THEY WILL BE ASKED TO SIGN A FORM THAT THEY ARE AWARE OF THE OBJECTIVES.

b) The prevention of crime and disorder

DO NOT SELL ALCOHOL TO ANY PERSON WHO APPEARS DRUNK.
IN CASE OF CONFLICT SEEK HELP AND WITNESSES. CALL POLICE IF PROBLEM IS GETTING OUT OF HAND.
WATCH FOR SIGNS OF DRUG/SUBSTANCE ABUSE,
KEEP RECORD OF ALL INCIDENTS.

c) Public safety

EXIT SIGNS OVER ALL DOORS.
FIRE ALARM CHECKED WEEKLY AND EMERGENCY LIGHTING.
FIRE EXTINGUISHERS AVAILABLE TO STAFF.
EMERGENCY LIGHTING.
EVACUATION ASSEMBLY POINT SIGNED.
LIMIT NUMBER OF PEOPLE ATTENDING PREMISES.

d) The prevention of public nuisance

ENSURE CLOSING TIMES ADHERED TO.
SIGNS REQUESTING CUSTOMERS TO LEAVE QUIETLY.
NO ALCOHOL TO BE SOLD TO BE TAKEN FROM THE PREMISES.
ALL DOORS AND WINDOWS CLOSED WHILST LIVE MUSIC PLAYING.
ALL REFUSE TO BE STORED UNTIL COLLECTION OR DISPOSAL.

e) The protection of children from harm

ENSURE BAR STAFF APPLY CHALLENGE 25 TO ENSURE ALCOHOL NOT SOLD TO UNDER 18s. IF STAFF NOT CONVINCED THAT A PERSON IS OVER 18 ASK FOR PROOF – PHOTO – DATE OF BIRTH
ENSURE ALCOHOL IS NOT PURCHASED FOR CONSUMPTION BY UNDER AGE PERSONS.
AS IN (a) WATCH FOR DRUG/SUBSTANCE ABUSE.
THE ASSOCIATION HAS A NUMBER OF MEMBERS WITH DBS CLEARANCE.

Checklist:

Please tick to indicate agreement

- I have made or enclosed payment of the fee.
- I have enclosed the plan of the premises.
- I have sent copies of this application and plan to the responsible authorities.
- I have completed and enclosed the club declaration and enclose a copy of the club rules.
- I understand that I must now advertise my application.
- I understand that if I do not comply with the above requirements my application will be rejected.

IT IS AN OFFENCE, LIABLE ON SUMMARY CONVICTION TO A FINE NOT EXCEEDING LEVEL 5 ON THE STANDARD SCALE, UNDER SECTION 158 OF THE LICENSING ACT 2003, TO MAKE A FALSE STATEMENT IN OR IN CONNECTION WITH THIS APPLICATION.

d guidance note

Post town	
Telephone number	
If you would prefe	

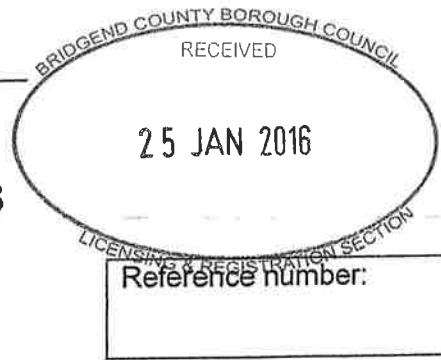

Declaration for a club premises certificate to be granted under the Licensing Act 2003

(1)

PLEASE READ THE FOLLOWING INSTRUCTIONS BEFORE COMPLETING DECLARATION

Before completing this form please read the guidance notes at the end of the form.

If you are completing this form by hand please write legibly in block capitals. In all cases ensure that your answers are inside the boxes and written in black ink. Use additional sheets if necessary. You may wish to keep a copy of the completed form for your records.

Club Premises details

Name of club PORTHCAWL ATHLETIC ASSOCIATION	
Postal address of club, if any, or, if none, Ordnance Survey map reference or description LOCKS LANE (Opp STRATFORD DRIVE)	
Post town PORTHCAWL	Postcode CF36 3HY.
Telephone number (if any) —	
E-mail (optional)	

CLUB DECLARATION AS TO QUALIFYING CLUB STATUS

(2) PORTHCAWL ATHLETIC ASSOCIATION club makes the following declarations

1) Where the club to which this application relates is:

- a registered society within the meaning of the Industrial and Provident Societies Act 1965;
 - a registered society within the meaning of the Friendly Societies Act 1974; or
 - a registered friendly society within the meaning of the Friendly Societies Act,
- the club declares that the club satisfies:

Please tick ✓ yes

Condition 1 in section 62(2) of the Licensing Act 2003
Please give relevant club rule number(s)

Condition 2 in section 62(3) of the Licensing Act 2003
Please give relevant club rule number(s)

(1) Insert name and address of relevant licensing authority and its reference number (optional)

(2) Insert name of club

Condition 4 in section 62(5) of the Licensing Act 2003

Please give relevant club rule number(s)

Does the club wish to supply alcohol to members and guests?
If yes the club declares that -

The purchase of alcohol for the club and the supply of alcohol by the club is under the control of the members or of a committee appointed by the members

Please give relevant club rule number(s), if any

2) Where the club to which this application relates is:
an association organised for the social well-being and recreation of persons employed in or about coal mines, the club declares that the club satisfies:

Condition 1 in section 62(2) of the Licensing Act 2003

Please give relevant club rule number(s)

Condition 2 in section 62(3) of the Licensing Act 2003

Please give relevant club rule number(s)

Does the club wish to supply alcohol to members and guests?
If yes, the club declares that it satisfies -

First condition in section 66(4) of the Licensing Act 2003

Please give relevant club rule number(s), if any

Second condition in section 66(5) of the Licensing Act 2003

Please give relevant club rule number(s), if any

3) Where the club to which this application relates does not fall into the categories in 1 and 2 above, the club declares that the club satisfies:

Condition 1 in section 62(2) of the Licensing Act 2003

Please give relevant club rule number(s)

Condition 2 in section 62(3) of the Licensing Act 2003

Please give relevant club rule number(s)



Condition 3 in section 62(4) of the Licensing Act 2003

The club's arrangements for restricting the club's freedom of purchase of alcohol are:

(a) contained in club rule number(s)

RULE 30 (3)

(b) or, as follows

(please provide a short description)

The club's provisions by which money or property of the club or any gain arising from the carrying on of the club is or may be applied for charitable benevolent or political purposes are:

(a) contained in club rule number(s)

RULE 4

(b) or, as follows

(please provide a short description)

The arrangements for giving members information about the finances of the club are:

(a) contained in club rule number(s)

RULE 9

(b) or, as follows

(please provide a short description)

Please describe details of the books of account and other records kept to ensure the accuracy of the information about finances given to members of the club or give the relevant rule number(s)

RULE 24. ANNUAL REPORT AND RETURNS AND ACCOUNTS.

Please tick yes

Condition 4 in section 62(5) of the Licensing Act 2003



Condition 5 in section 62(6) of the Licensing Act 2003



The club proposes to supply alcohol to members and guests and declares that the club satisfies:

additional condition 1 in section 64(2) of the Licensing Act 2003



Please give relevant club rule number(s), if any

RULE 30 (3)

additional condition 2 in section 64(3) of the Licensing Act 2003



Please give relevant club rule number(s), if any

RULE 30 (3) d+e

additional condition 3 in section 64(4) of the Licensing Act 2003



Please give relevant club rule number(s), if any

RULE 30 (3) ii and RULE 30 (4)

IT IS AN OFFENCE, LIABLE ON CONVICTION TO A FINE UP TO LEVEL 5 ON THE STANDARD SCALE, UNDER SECTION 158 OF THE LICENSING ACT 2003 TO MAKE A FALSE STATEMENT IN OR IN CONNECTION WITH THIS APPLICATION

PETER DOWNES

I, **PETER DOWNES**, make this declaration on behalf of the club and have authority to bind the club

Signature

P. Downes

Date

25/1/2016

Capacity

SECRETARY.

**NOTE:-
ALL DIMS TO BE CHECKED PRIOR
TO COMMENCEMENT OF WORK ON SITE**

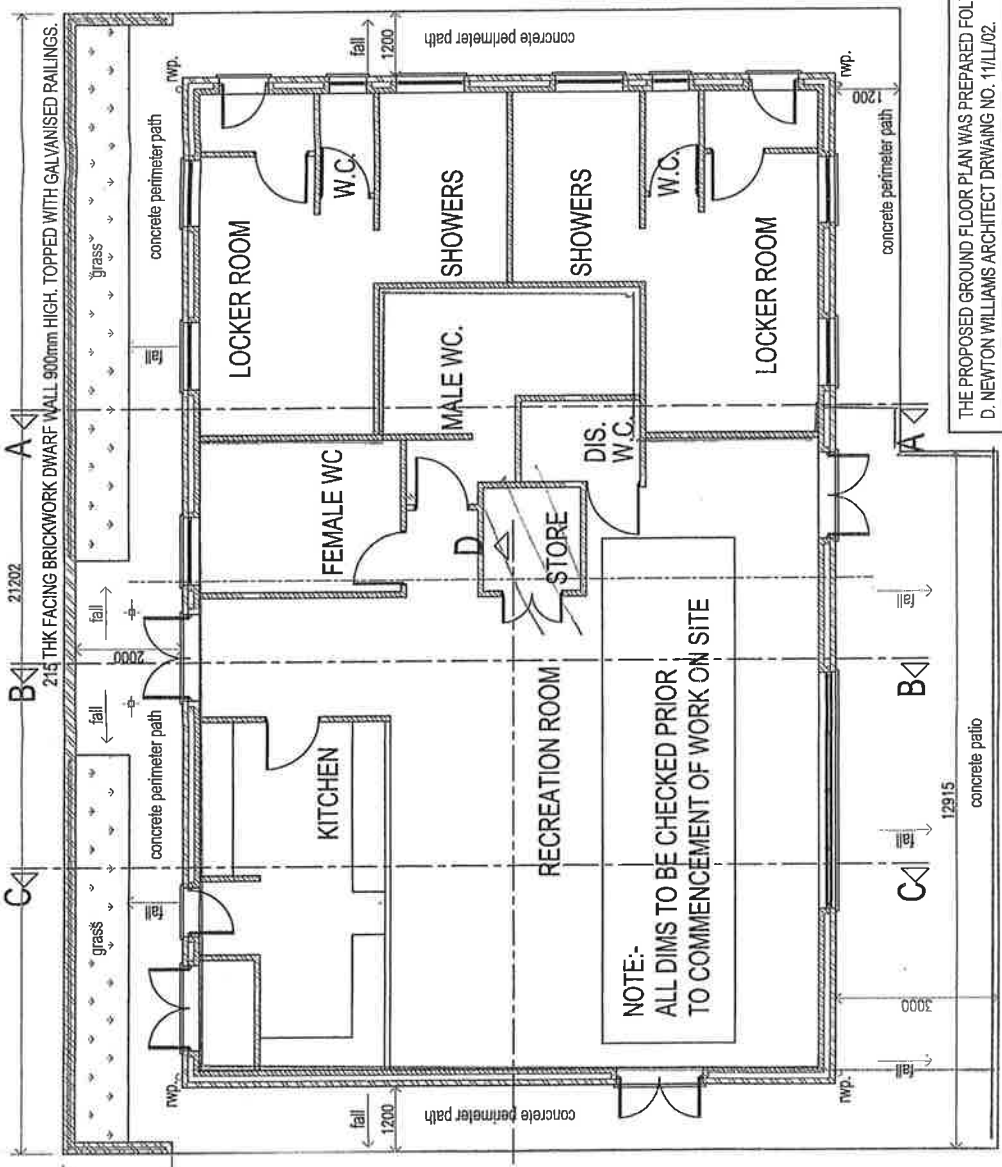

THE PROPOSED GROUND FLOOR PLAN WAS PREPARED FOLLOWING
D. NEWTON WILLIAMS ARCHITECT DRAWING NO. 11/11/02.

PROPOSED EXTERNAL WORKS PLAN.
(1:100)

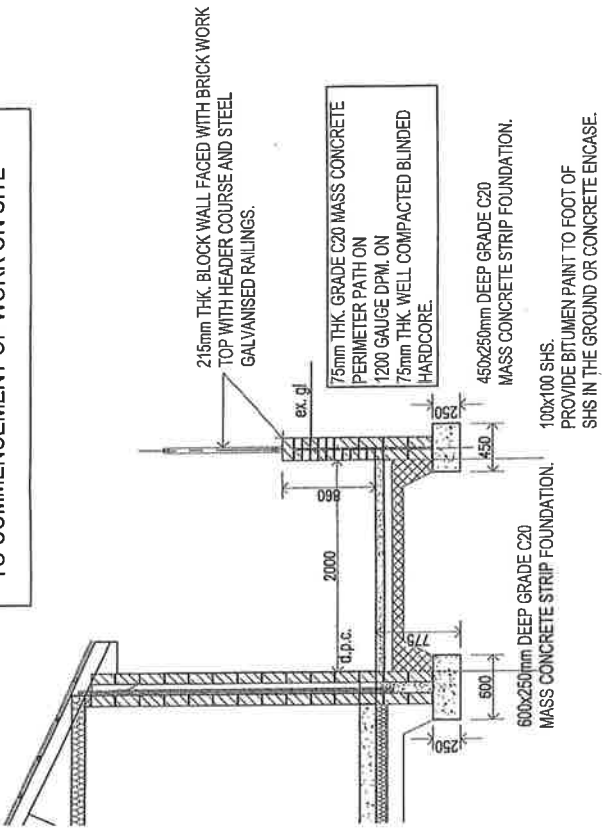

SECTION B-B. (THROUGH FOOTPATH).
(1:50)

revisions:	A - EXTERNAL WINDOW OPENING REDUCED DOOR CANOPY REMOVED
CLIENT	PORHCRAWL ATHLETIC ASSOCIATION
job title	PROPOSED CLUB HOUSE @ LOCKS LANE PORHCRAWL
drawing title	PROPOSED EXTERNAL WORKS PLAN.
Job No:	13.05
drawing No:	10 rev 'A'
scales:	1:100, 1:50

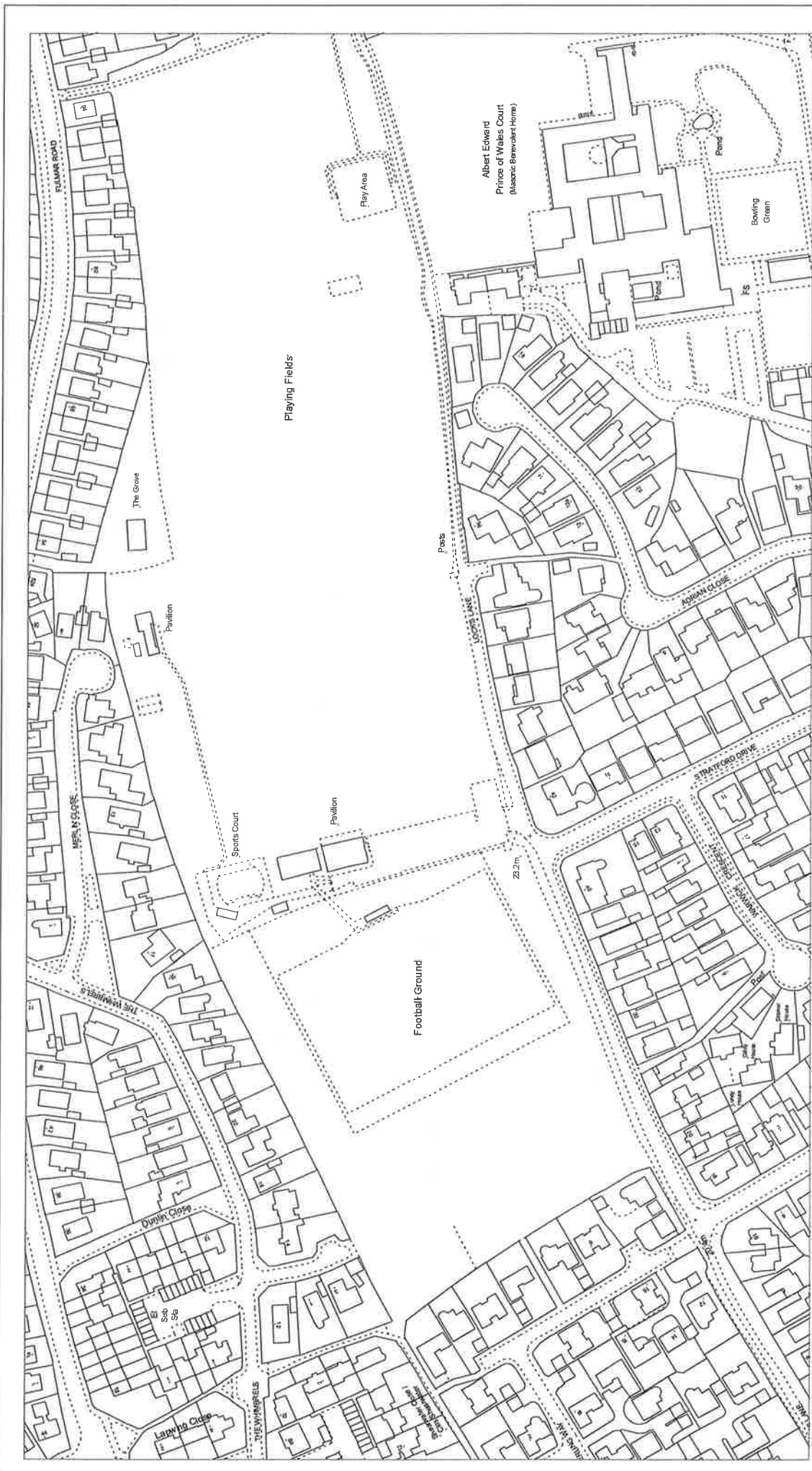

COMMITTEE REPORT

1:2500
 Time of Plot: 12:06
 Date of Plot: 03/03/2016
 Plot generated by: YW
 Department : LARS

Cynghor Bwrdeistref Siral

Pery-pont ar Ogrw

BRIDGEND
 County Borough Council

Darren Mepham
 Chief Executive

Crown Copyright and database right 2016. Ordnance Survey 100023405.
 Aerial Imagery: Cities Revealed aerial photography copyright The
 GeoInformation Group 2013.
 Countryside Council for Wales, © Crown Copyright and database right 2016.
 Ordnance Survey 100018813.
 Forestry Commission, © Crown Copyright and database right 2016. Ordnance
 Survey 100023498.

licensing

From: David Richards [REDACTED]
Sent: 21 February 2016 17:52
To: licensing
Subject: PAA application Locks Lane Porthcawl

Dear Sir/Madam

I object to the application by PAA for a licence for the club house at Locks Lane Porthcawl on the following grounds

1. Traffic

Locks Lane is an alternative roadway from Mallards Way through to the entrance to the Locks Lane Playing Fields and is residential on one side of the road the other side being a hedge and stone wall. Additional traffic attending the club house would result in additional disturbance, noise and obstruction to residents of Locks Lane. In particular late at night.

Over the last 2 /3 years objections have been made through local Coucillors and residents meetings regarding the parking of motor cars in Locks Lane as a result of the overflowing of the car park at locks Lane. This has resulted in emergency vehicles not having access to domestic premises in Locks Lane.

On many occasions the gates of the car park at Locks Lane car park have been left open on occasions for days allowing access to other vehicles including camper vans. This matter continues.

2 Environment.

Locks Lane is a residential area. the majority of the residents are aged. The additional noise of the music from the club house and the vehicles leaving the premises after 11pm at night would be detrimental to the well being of the residents.

The noise from the music already being played at the club house constitutes noise pollution, Locks Lane is an authorised cycle route and signed as such by BCBC. any increase in traffic flow would bring additional vehicles into the area to the detriment of cyclist the majority of whom are very young persons learning to ride their cycles.

Licensing Hours

The majority of the persons utilising the facilities at Locks Lane are members of the childrens section and therefore they would not be attending the club house in the evenings or late at night. In the hours published the club house in effect becomes a full public house. Prior to the change to PAA Locks Lane grounds were a playing field not a soccer/cricket club and as such residents purchased their property overlooking playing fields not a sporting club with a public house type licence/ premises as a club louse.

The location of the club house is in close proximity to the houses in Fulmar Road as well as Locks Lane and they no doubt will also suffer from noise pollution if the club are granted a music licence until 11pm.

David Richards MBE
[REDACTED]

Please acknowledge receipt of this objection.

licensing

From: David Richards [REDACTED]
Sent: 29 February 2016 09:01
To: licensing
Subject: Re: PAA application Locks Lane Porthcawl

Further to my previous correspondence concerning the application by PAA.
[REDACTED]

Thank you
David Richards

From: licensing <licensing@bridgend.gov.uk>
To: David Richards [REDACTED]
Sent: Monday, 29 February 2016, 8:11
Subject: RE: PAA application Locks Lane Porthcawl

The Licensing Section acknowledges receipt of your email.

Regards
Licensing
Bridgend County Borough Council
Civic Offices
Angel Street
BRIDGEND
CF31 4WB
01656 643643
Email: licensing@bridgend.gov.uk
Text phone | Ffon testun: 18001 01656 643643

From: David Richards [REDACTED]
Sent: 26 February 2016 16:24
To: licensing
Subject: Re: PAA application Locks Lane Porthcawl

For the attention of Yvonne Witchell

Thank you for the information. I draw your attention to item 2 and 4 of the licensing objectives and your comment that Traffic and Parking are not within the remit of the licensing authority. I must disagree with you in that in this case and perhaps only in this case public safety and protection of children from harm does apply.

As stated in my original letter of objection Locks Lane is an authorised cycle route designed and maintained by BCBC and as such attracts cyclists of all ages but in particular novice young cyclist learning to ride in a route which for the majority of the time is without vehicular traffic. However the exit from Locks Lane car park is on to that very authorised cycle path and therefore any increase in vehicular traffic brings into it the aspect of not only public safety but also protection of children from harm. I must stress that there have been many occasions within the last 2 years when the car park at Locks Lane has been full and vehicles have parked in such a manner in Locks Lane that the Police have ticketed such vehicles as causing an obstruction which of course leads to a narrowing of the roadway which in turn leads to a safety factor for members of the public, cyclists, pedestrians and of course horse riders who also utilised Locks Lane.

I would suggest a site meeting for members of the licensing committee. They will see

that any increase in traffic which will result from this licencing application does raise the percentage in favour of accidents to adults,children and of course other vehicles.

I have no objection to my name and address being known.

David Richards MBE 46 Locks Lane,Porthcawl CF36 3HY.

I have already given the above name and address to your environmental dept.

My local borough Councillor Mr Gerald Davies is fully aware of the dangerous traffic conditions in this area as a result of the inability of PAA to control the number of teams playing at Locks Lane at the same time.

I look forward to hearing from you.

licensing

From: James Thomas [REDACTED]
Sent: 28 February 2016 17:41
To: licensing
Cc: David Richards; [REDACTED] Nda Jones
Subject: Reply re PAA's application for alcohol / music licence at Lock's Lane changing facility.

Dear Ms Witchell,
in reply to your recent e mail, please find my comments which all relate to the 4 topics itemized.

- 1) **DISORDER** : My objection refers to the rowdy behaviour all ready reported, relating to people leaving the premises after 23.00 **on foot** and causing disturbance along Lock's Lane and Stratford Drive. (Historical fact).
- 2) **PUBLIC SAFETY** : This is a quiet, residential area, populated by mostly elderly people and I for one would not wish to be walking a dog and risk confrontation with such people as mentioned above if they are at all alcohol driven.
With public safety in mind, please see attached photograph, taken by myself of alternative use of the lane which would surely be jeopardized by increase in use.

- 3) **PREVENTION OF PUBLIC NUISANCE** : a) Noise pollution at any time of the day is unacceptable and music at the volumes already experienced until 23.00 is certainly unacceptable and would change the entire aspect of living in the surrounding premises. b) People who have drunk alcohol leaving these premises on foot or by other means after 23.00 would surely cause public nuisance as already mentioned in 1).
- 4) **PROTECTION OF CHILDREN FROM HARM** : Children are regular users of these grounds. To date, litter has increased considerably and it should be a consideration of BCBC's that discarded drink cans and especially drink bottles which are likely to get broken, might be present in the grass in front of the premises - do BCBC really want to run that risk of injury to a child?

The license application is to serve alcohol and play live music until 23.00. I have not been informed of what time the building is to be closed, locked and car park gates locked - all of which will have a bearing on the time that people will be vacating the grounds on foot or otherwise.

Finally, do BCBC really want to change the lives of rate paying residents in such a dramatic and destructive way?

James Thomas,
38 Lock's Lane,
Porthcawl.
CF36 3HY

I am happy for my name and address to be published.

PLEASE CONFIRM RECEIPT OF THIS REPLY EMAIL

licensing

From: James Thomas [REDACTED]
Sent: 21 February 2016 15:21
To: licensing
Cc: LYnda Jones; Cllr Gerald Davies; [REDACTED]
Subject: re APPLICATION TO SERVE ALCOHOL AND HAVE LIVE MUSIC AT LOCK'S LANE CHANGING FACILITY, PORTHCAWL. APPLICANT PORTHCAWL ATHLETIC ASSOCIATION

In the absence of any other formal documentation, please accept this e mail as a written objection against the above application.

No notification nor the usual forms to register complaints have been issued to any of the local residents.

Only, 3 notices on the above premises have been displayed which are on view by chance visits.

The application includes licence to **sell alcohol and have live music played until 23.00 on Fridays and Saturdays** along with applications for other days including Sunday until 18.00.

This application holds no regard for the disturbance that this kind of activity will cause to residents in a quiet environment situated on a listed, single track lane and also a designated cycle path.

The noise level from live musical performances until 23.00 will ruin the peaceful neighbourhood. The traffic that will be leaving the premises at such a late hour will inevitably have an adverse affect on the local environment.

Noise pollution is an unacceptable value that should always be considered when a *new* building is permitted by license to play live music especially when it is in such close proximity to residential dwellings that were built and purchased long before any "club facility" was built. [REDACTED]

No one can say that the granting of the above application will NOT have an affect on the residents and environment, quite the opposite.

I look forward to receiving confirmation of receipt of this objection and to an early reply with your comments.

Yours faithfully,

JAMES THOMAS,

38 Lock's Lane,
Porthcawl.

James Thomas
[REDACTED]

TEL [REDACTED]
MOB [REDACTED]

This page is intentionally left blank

licensing

From: RJ Griffiths [REDACTED]
Sent: 22 February 2016 21:41
To: licensing
Subject: Porthcawl Athletic Association Application for Club Premises Licence

I live in a bungalow on the south side of Merlin Close that is located in the close vicinity of the PAA clubhouse.

PAA wish to supply alcohol every day of the week mostly up to 10pm or 11.pm, and to provide recorded or live music during the same pattern of hours. I am concerned that this could create public disturbance or nuisance, especially noise late at night. Perhaps the open hours can be shortened.

I hope that enforcement visits will confirm that PAA have taken the necessary action to meet the licensing objectives and that my concern will be unfounded.

R J Griffiths, 12 Merlin Close, Porthcawl, CF36 3UB

This page is intentionally left blank

licensing

From: jeffrey hodgson [REDACTED]
Sent: 21 February 2016 23:37
To: licensing
Subject: PAA Application Locks Lane Porthcawl

Dear Sir / Madam

I wish to register my objections to the PAA Licence application for the club house at Locks lane Porthcawl. I bring to your attention the following objections:

- There is a long recorded history of traffic and parking problems in relation to the inadequately sized car park serving the complex applying to the licence. The granting of a licence will increase traffic and create an even greater overspill onto the narrow roadways of Locks Lane.
- The access and egress point of the car park is blind. Cars travelling towards the club car park cannot be seen by emerging cars from the car park. There is no "vision splay" normally required when such developments are initially granted planning permission. This has been previously pointed out during the consultation period for the initial development of the soccer clubhouse. I would observe that there have been numerous occasions where cars emerging from the car park have driven straight out without any regard for oncoming traffic. The additional traffic using the car park at night time will, without doubt increase the risk of an accident.
- The officers of the present clubs using the premises have no credible system to manage traffic, and this is evidence when parking (without exception on match days), spills out onto the narrow roadways of Locks Lane and often prevents access for residents. In the event that an emergency vehicle should need access, this is a foreseeable risk. The licence will serve to increase the volume of traffic and increase the risk and inconvenience identified.
- The young people using the club house, will if the licence is granted be effectively be in a licensed premises. Is this a suitable environment for young children wishing to play sports. Will children of eight or younger be allowed on premises where alcohol is being served ?.
- The noise generated as a result of the application including a music licence will be problematic particularly as the premises is in close proximity to housing occupied predominately by older residence who have chosen to live in the locality because of quiet

This page is intentionally left blank

licensing

From: Robert Jones [REDACTED]
Sent: 22 February 2016 08:41
To: licensing
Subject: Changing rooms at locks lane porthcawl

Dear Sirs

We wish to object to the granting of a licence at the above premises.

We have experienced the noise and disturbance during and after the closing of a football club event with a temporary licence. We have made the planning department aware of our concerns as we live at 40Locks Lane and I am afraid the behaviour of the people leaving was disgraceful and very frightening to elderly residents in the late evening, when we are already in bed.

We pay high rates commensurate with a quiet area and consider that there are sufficient outlets for alcohol consumption in Porthcawl already and they are used to the unacceptable behaviour that licencing causes these days.

We cannot rely on the police to regulate poor behaviour, and unfortunately in spite of PAA's statements they have proved unreliable in the past at looking after the residents whose access to their homes has been considerably impaired due to inconsiderate parking, when PAA have promised to supervise.

Again we would ask that you consult the highways department for all previous correspondence before any decisions are made.

Mr and Mrs Jones

Sent from my iPad

Yvonne Witchell

From: licensing
Sent: 03 March 2016 15:00
To: Yvonne Witchell
Subject: FW: 2 pictures of PAA function on 25/07/15 taken at 7.07pm evidence in relation to PAA licence application for musicand alcohol
Attachments: DSC01259.JPG; DSC01260.JPG

For your attention.

From: Lynda Jones [mailto: [REDACTED]]
Sent: 03 March 2016 14:58
To: licensing
Cc: Cllr Gerald Davies; david richards
Subject: Fw: 2 pictures of PAA function on 25/07/15 taken at 7.07pm evidence in relation to PAA licence application for musicand alcohol

----- Original Message -----

From: Lynda Jones
To: [REDACTED]
Cc: lynda.jones
Sent: Thursday, March 03, 2016 1:54 PM
Subject: 2 pictures of PAA function on 25/07/15 taken at 7.07pm

These photos show that even though the function on 25 July last year finished officially at 6pm (I believe), the doors were open for internal noise to drift over to Locks Lane, and of course as you can see from one of the photos, (taken at 7.07pm), showing raised hands, people were drinking alcohol, were very animated, and I can assure you were very noisy. After some time the doors were closed and the noise was muted.

However as mentioned to [REDACTED] of the Parks and Playing Field BCBC department, unfortunately as people eventually left the premises at approximately 10.45pm, those on foot streamed down Stratford Drive, and were making enough noise to disturb my sleep.

When I looked onto the road, people were walking in the centre of Stratford Drive and not on the pavement in an orderly fashion.

Clearly there are already proved issues of nuisance to the residents of Locks Lane to be considered by any Licencing authority, and that particular function was for a much more limited period than the extended hours and regular drinking and entertainment times PAA's application is requesting.

PAA may well give assurances that they will caution their members to act in a less raucous fashion.

Unfortunately as BCBC are already aware, assurances on bollarding the roads outside the Playing Fields to ensure residents can safely access their properties, has consistently failed to occur.

We clearly cannot keep calling out the police, for parking or nuisance, as has been suggested by [REDACTED] and in any event on a Saturday night we have been told that the police are fully stretched and would be unlikely to attend any disturbance in Locks Lane.

I sincerely hope these points will be taken into account. We can only ask that the peaceful environment in which we have lived for 42 years will not be materially changed and spoilt on every weekend evening for the foreseeable future.

Robert and Lynda Jones
40 Locks Lane
Porthcawl Cf36 3HY

[REDACTED]

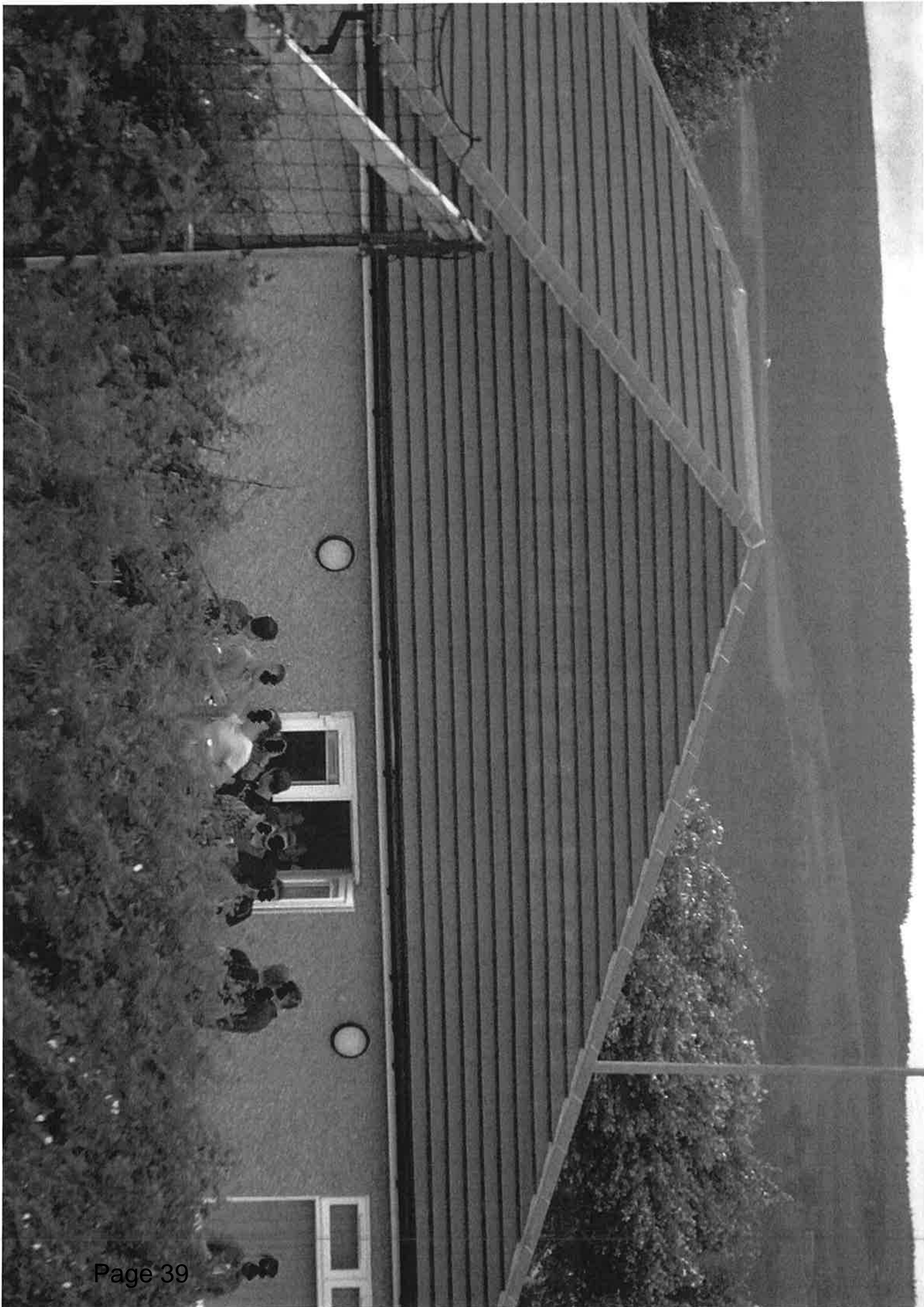

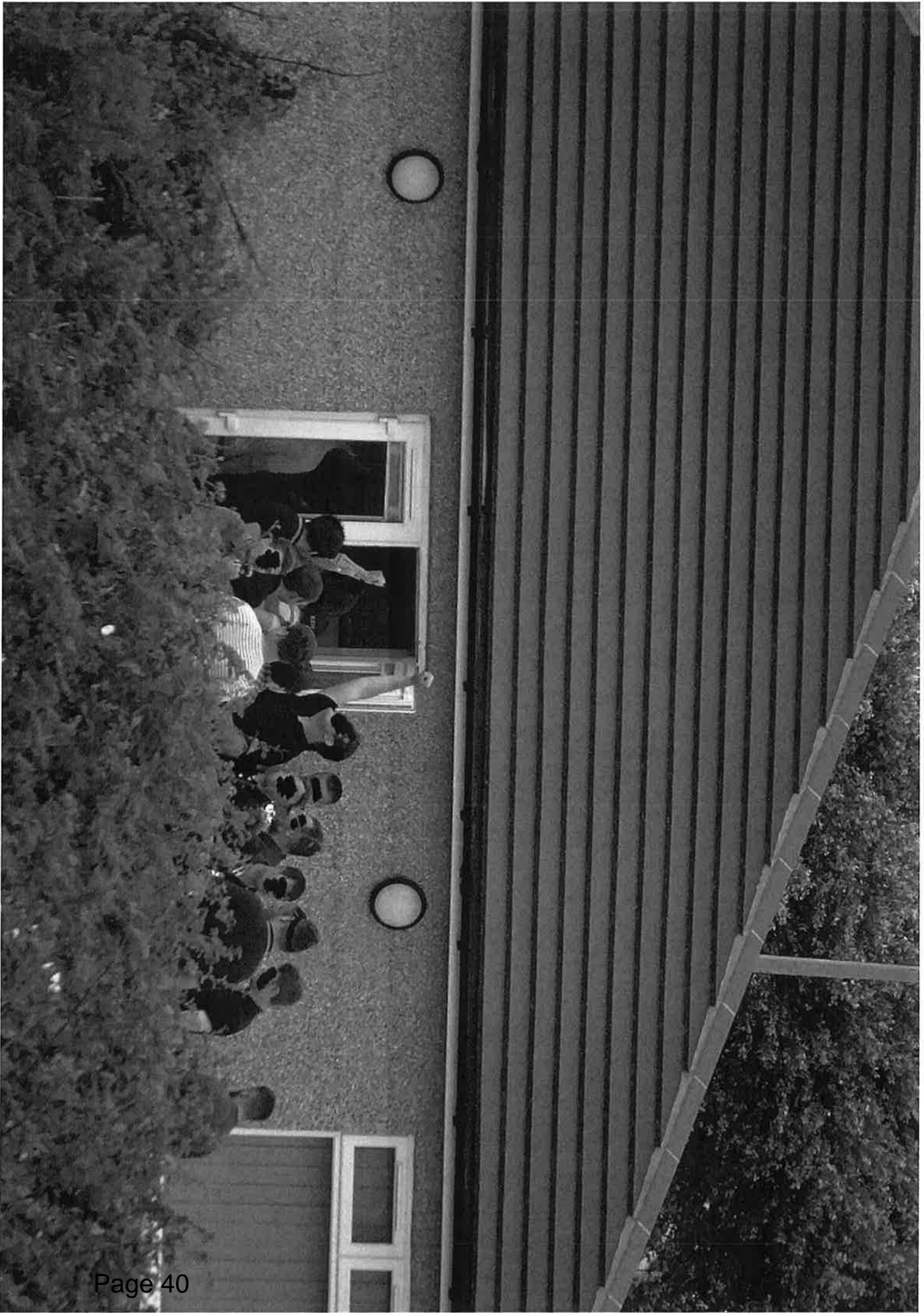

Additional conditions in relation to the prevention of Public nuisance

- 1) No bottles, to be taken to the external area,
 - 2) Any alcohol to be taken to the external area will be decanted into plastic containers.
 - 3) Signs will be placed near all exits stating customers please respect the neighbourhood and leave quietly.
 - 4) The committee shall make regular patrols of the outside area to prevent underage persons committing anti social behaviour within the area.
 - 5) Members will be asked to show their membership card on purchase of alcohol if membership is in doubt.
 - 6) No 18's birthday parties will be booked or take place at the premises.
 - 7) When open outside of the licensing hours or when hosting children events, alcohol will not be on display or sold.
-
1. All staff shall be trained in all aspects of the Licensing Act 2003 on the commencement of employment, then annually or more frequently if necessary. Signed records will be kept on the Club premises.
 2. Challenge 25 will form part of the premises age verification policy, ID, in the form of driving licence, passport or PASS card, will be requested from all persons who appear to be under the age of 25
 3. Challenge 25 signage will be displayed prominently in all service areas.
-
- ASSISTANT CHIEF EXECUTIVE LEGAL AND REGULATORY SERVICES /
PRIF WEITHREDWR CYNORTHWYOL GWASANAETHAU CYFREITHIOL A RHEOLEIDDIOL
Mr. P. A. Jolley
-
4. The Club will ensure staff record any refusals of the supply of alcohol electronically or by way of a Refusals Register.

This page is intentionally left blank